



## Product Model Number

CKO-CH15-085040-5005

### ✓ Model Number Definitions

**CKO-XXXX-XXXXXX-XXXX**



- A. Chun Kuang Optics Corp. Product
- B. Product Type: product abbreviation  
Ex:  
CH→CoB High Intensity  
CC→CoB Compact  
CS→Soft Shading for CoB LED  
HC→Holder for CoB LED

- C. Identity Code
- D. Lens / Fixture Size  
Ex: 075026=Φ75mm / Thickness=26mm (round up)
- C. Serial Numbers

The lens datasheet is applicable for **Citizen LED**, that manufactured by Chun Kuang Optics Corp.

### ✓ Dimensions (mm) : Φ85 x 39.7

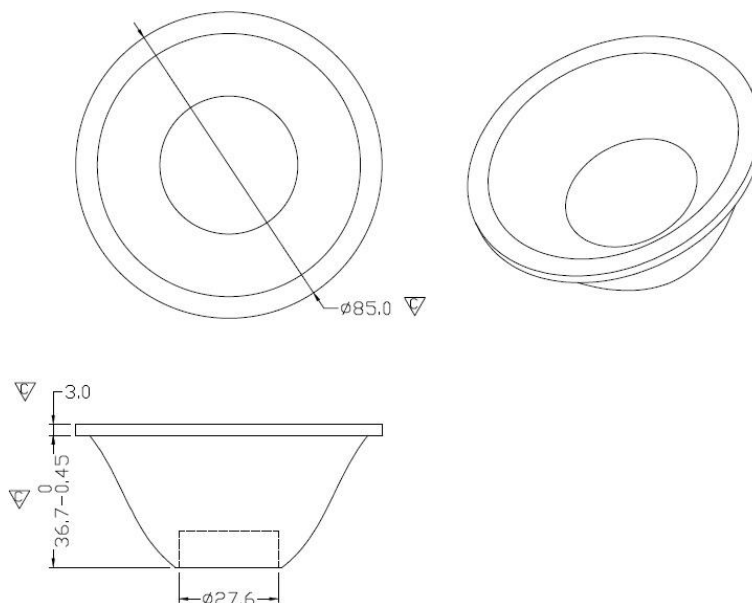

▽:Critical Dimension





## Optical Characteristics

Model Number	CKO-CH15-085040-5005	<p>"H" definition</p> <p>LES CoB</p>	
LED	<b>CLU 024</b>		
LES / LED Size	Φ 9.8 mm		
FWHM (D50)	31°		
Field Angle (D10)	61°		
H (distance)	3.65 mm		
Dimension	Φ =85 mm, Thickness=39.7 mm		
Luminous Flux	892.6 lm		Measured @ 9.5 W
Material	PC / UL94V2		

## cd/klm

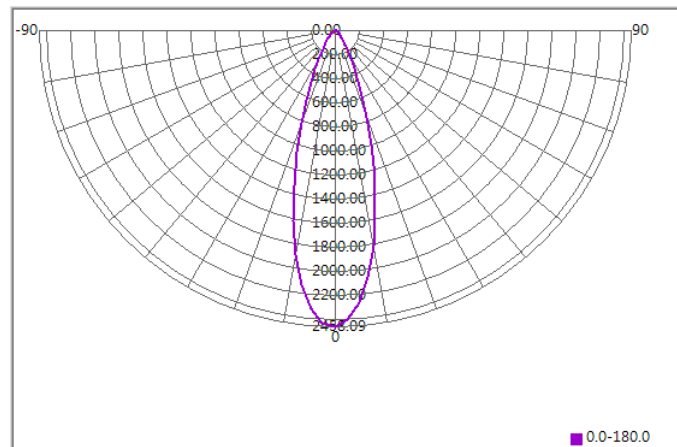

## Illuminance At Distances

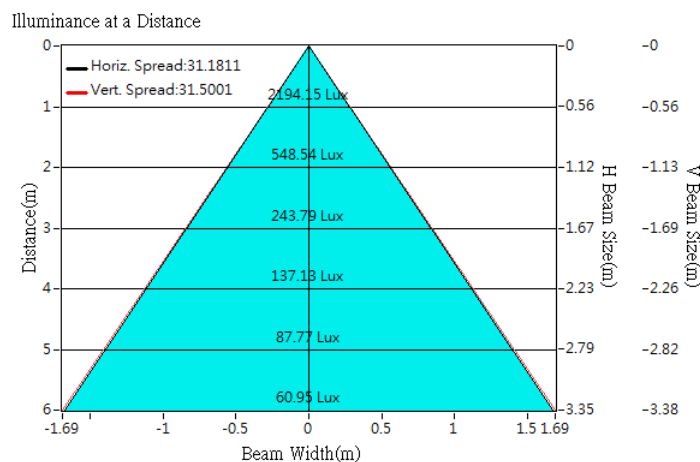



## Optical Characteristics

Model Number	CKO-CH15-085040-5005		<p>"H" definition</p> <p>LES CoB</p>
LED	<b>CLU 720</b>		
LES / LED Size	Φ 11 mm		
FWHM (D50)	33°		
Field Angle (D10)	63°		
H (distance)	3.65 mm		
Dimension	Φ =85 mm, Thickness=39.7 mm		
Luminous Flux	3192 lm	Measured @ 38.9 W	
Material	PC / UL94V2		

## cd/klm

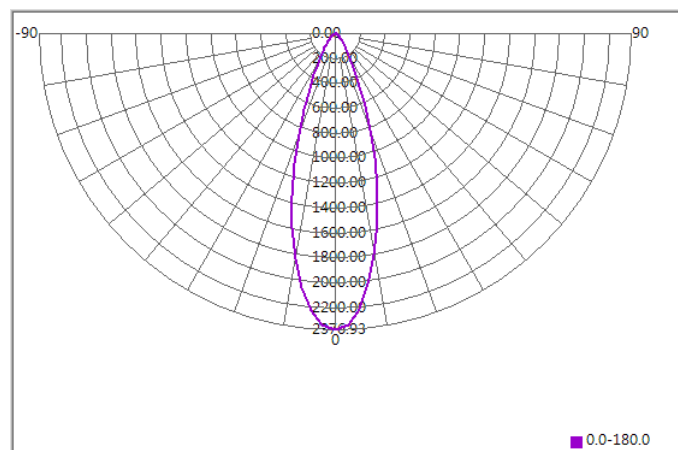

## Illuminance At Distances

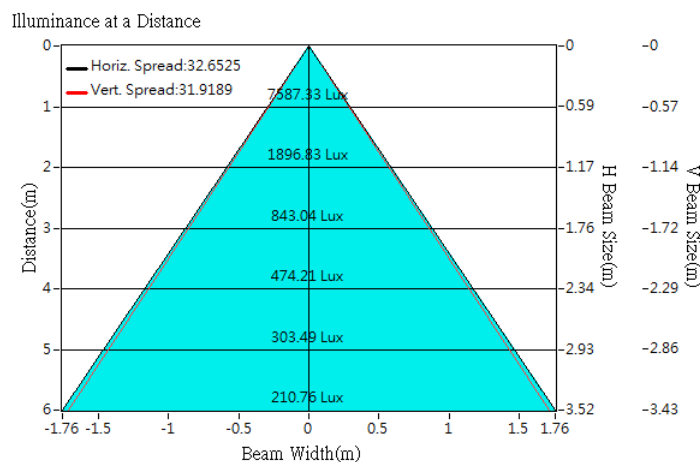



## Optical Characteristics

Model Number	CKO-CH15-085040-5005		<p>"H" definition</p>
LED	<b>CLU 730</b>		
LES / LED Size	Φ 13 mm		
FWHM (D50)	35°		
Field Angle (D10)	65°		
H (distance)	3.65 mm		
Dimension	Φ =85 mm, Thickness=39.7 mm		
Luminous Flux	4603 lm	Measured @ 64.5 W	
Material	PC / UL94V2		

## cd/klm

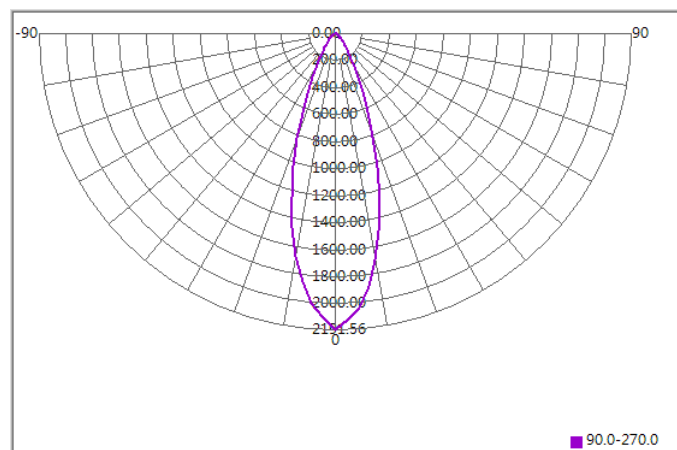

## Illuminance At Distances

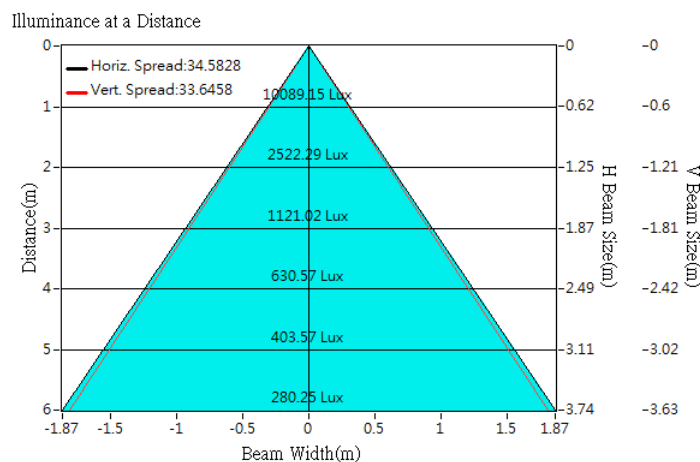



## Optical Characteristics

Model Number	CKO-CH15-085040-5005	<p>"H" definition</p> <p>LES CoB</p>	
LED	<b>CLU 038</b>		
LES / LED Size	Φ 14.5 mm		
FWHM (D50)	34°		
Field Angle (D10)	65°		
H (distance)	3.65 mm		
Dimension	Φ =85 mm, Thickness=39.7 mm		
Luminous Flux	2644 lm		Measured @ 25.0 W
Material	PC / UL94V2		

## cd/klm

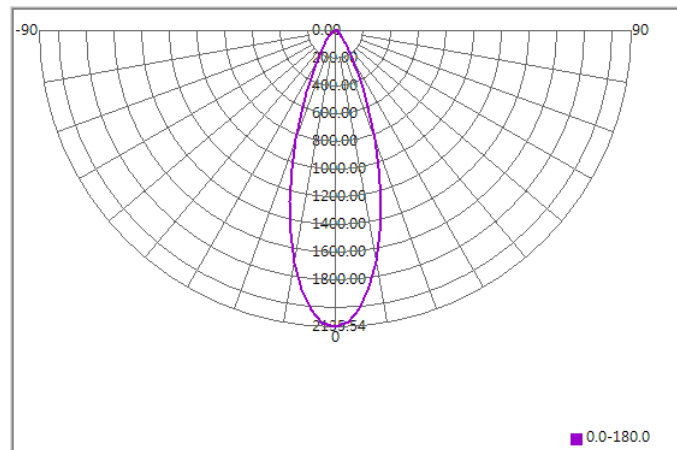

## Illuminance At Distances

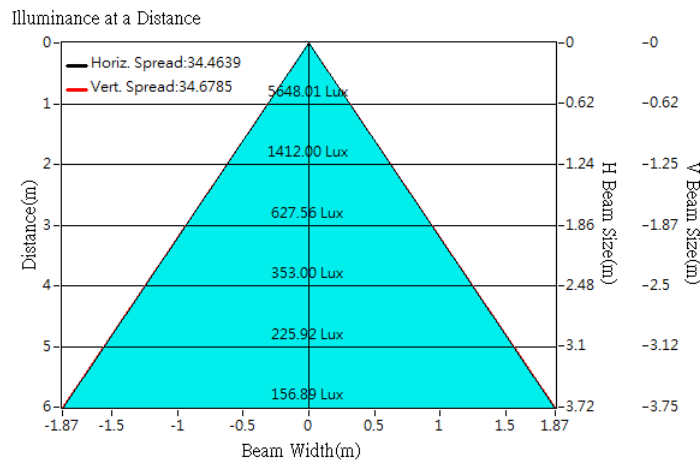



## Optical Characteristics

Model Number	CKO-CH15-085040-5005		<p>"H" definition</p> <p>LES CoB</p>
LED	CLU 036		
LES / LED Size	Φ 14.5 mm		
FWHM (D50)	36°		
Field Angle (D10)	67°		
H (distance)	3.65 mm		
Dimension	Φ =85 mm, Thickness=39.7 mm		
Luminous Flux	1859 lm	Measured @ 15.7 W	
Material	PC / UL94V2		

## cd/klm

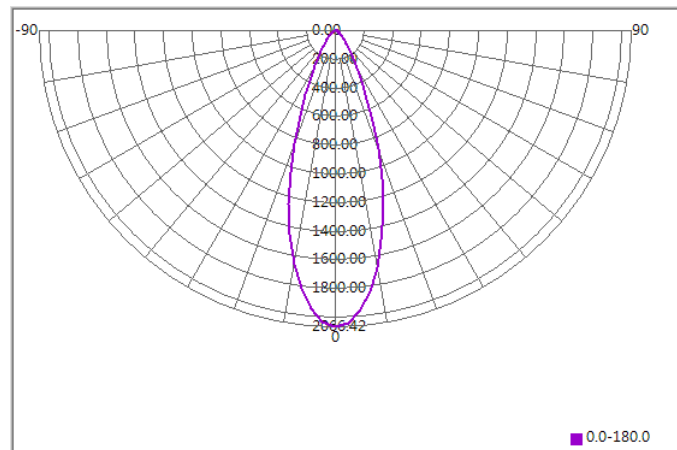

## Illuminance At Distances

