



## Product Model Number

CKO-CH19-030015-2501

### ✓ Model Number Definitions

**CKO-XXXX-XXXXXX-XXXX**

↑      ↑      ↑                      ↑                      ↑

(A)    (B)    (C)                      (D)                      (E)



- A. Chun Kuang Optics Corp. Product
- B. Product Type: product abbreviation  
Ex:  
CH→CoB High Intensity  
CC→CoB Compact  
CS→Soft Shading for CoB LED  
HC→Holder for CoB LED

- C. Identity Code
- D. Lens / Fixture Size  
Ex: 075026=Φ75mm / Thickness=26mm (round up)
- E. Serial Numbers

The lens datasheet is applicable for **Luminus LED**, that manufactured by Chun Kuang Optics Corp.

### ✓ Dimensions (mm) : Φ30 x 15

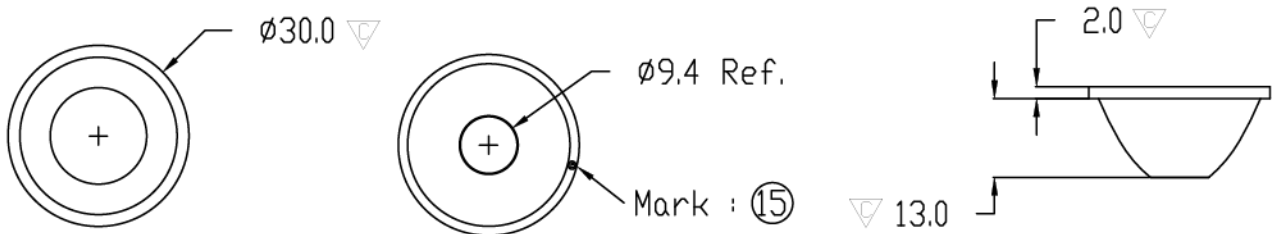

▽:Critical Dimension





## Optical Characteristics

Model Number	CKO-CH19-030015-2501		<p>"H" definition</p>
LED	CXM-3-AC40		
LES / LED Size	Φ 3.5 mm		
FWHM (D50)	15°		
Field Angle (D10)	34°		
H (distance)	2.5 mm		
Dimension	Φ =30mm, Thickness=15mm		
Luminous Flux	285 lm	Measured @ 2.79 W	
Material	PC / UL94V2		

## cd/klm

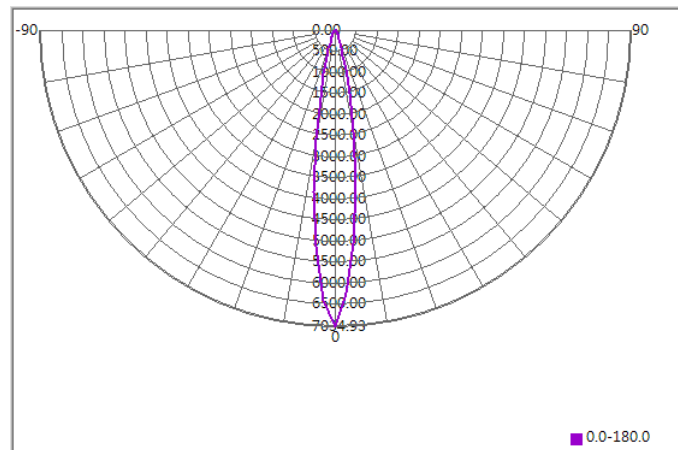

## Illuminance At Distances

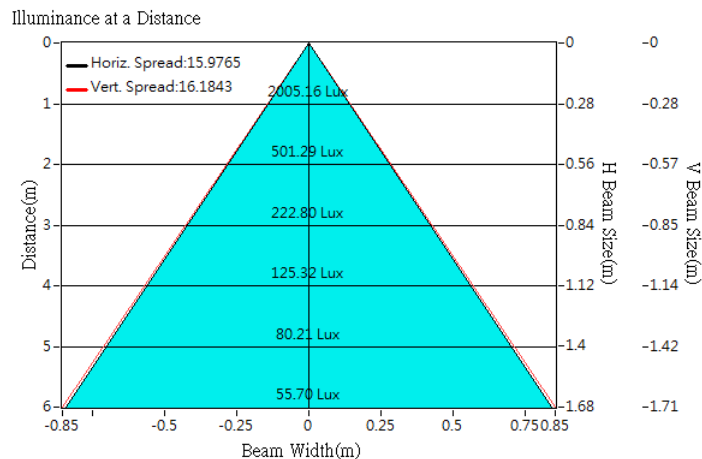



## Optical Characteristics

Model Number	CKO-CH19-030015-2501	<p>"H" definition</p> <p>LES CoB "H" mm (distance)</p>
LED	<b>CXM-4-AC40</b>	
LES / LED Size	Φ 4.5 mm	
FWHM (D50)	17°	
Field Angle (D10)	39°	
H (distance)	2.5 mm	
Dimension	Φ =30mm, Thickness=15mm	
Luminous Flux	423 lm      Measured @ 4.0 W	
Material	PC / UL94V2	

## cd/klm

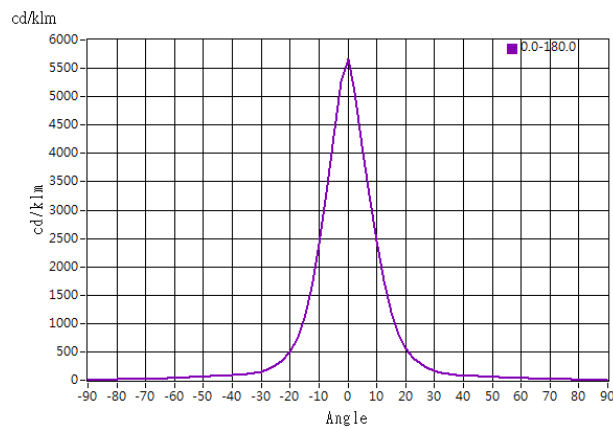

## Illuminance At Distances

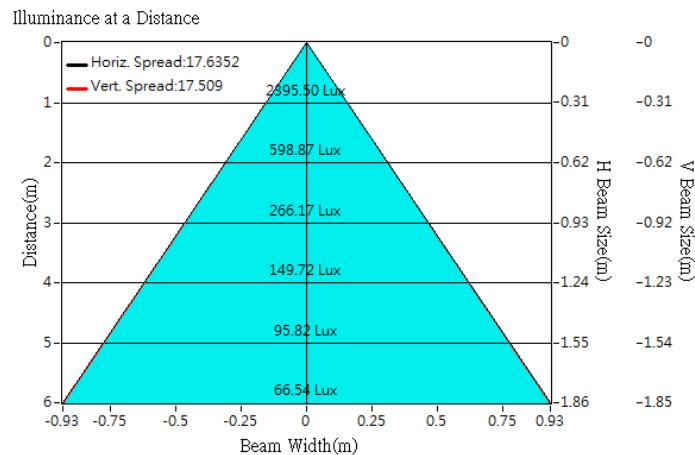



## Optical Characteristics

Model Number	CKO-CH19-030015-2501	<p>"H" definition</p>
LED	<b>CXM-6-AC40</b>	
LES / LED Size	Φ 6.3 mm	
FWHM (D50)	21°	
Field Angle (D10)	48°	
H (distance)	2.5 mm	
Dimension	Φ =30mm, Thickness=15mm	
Luminous Flux	666 lm      Measured @ 5.0 W	
Material	PC / UL94V2	

## cd/klm

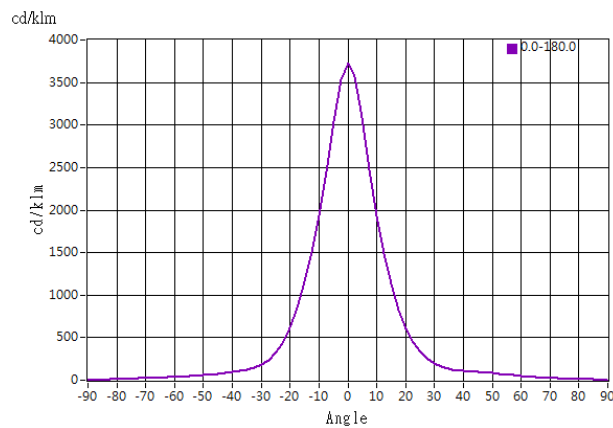

## Illuminance At Distances

