



Product Model Number

CKO-CH19-030015-2505

✓ Model Number Definitions

CKO-XXXX-XXXXXX-XXXX



- A. Chun Kuang Optics Corp. Product
- B. Product Type: product abbreviation
Ex:
CH→CoB High Intensity
CC→CoB Compact
CS→Soft Shading for CoB LED
HC→Holder for CoB LED

- C. Identity Code
- D. Lens / Fixture Size
Ex: 075026=Φ75mm / Thickness=26mm (round up)
- E. Serial Numbers

The lens datasheet is applicable for **Luminus LED**, that manufactured by Chun Kuang Optics Corp.

✓ Dimensions (mm) : Φ30 x 15

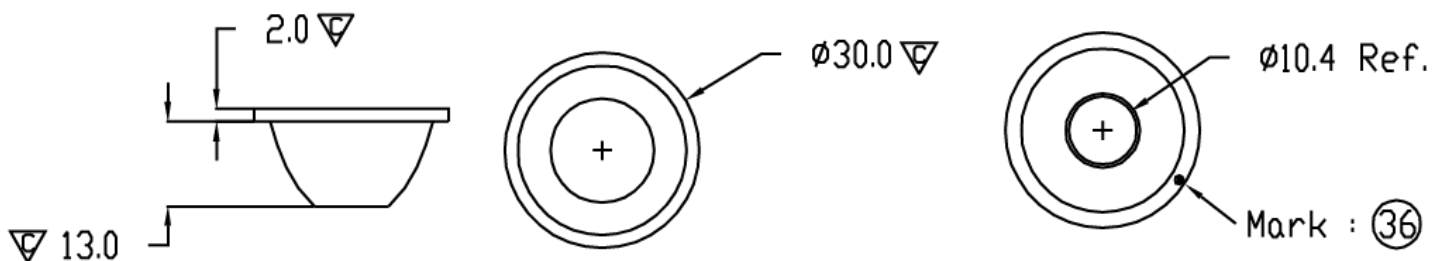

▽:Critical Dimension

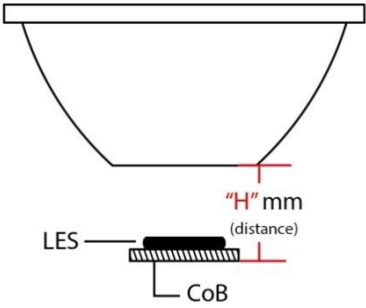

Optical Characteristics

Model Number	CKO-CH19-030015-2505		<p>"H" definition</p> 
LED	CXM-3-AC40		
LES / LED Size	Φ 3.5 mm		
FWHM (D50)	31°		
Field Angle (D10)	62°		
H (distance)	2.5 mm		
Dimension	Φ =30mm, Thickness=15mm		
Luminous Flux	284 lm	Measured @ 2.8 W	
Material	PC / UL94V2		

cd/klm

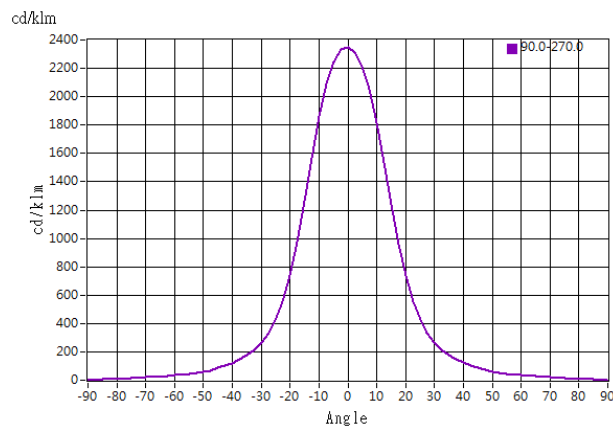

Illuminance At Distances

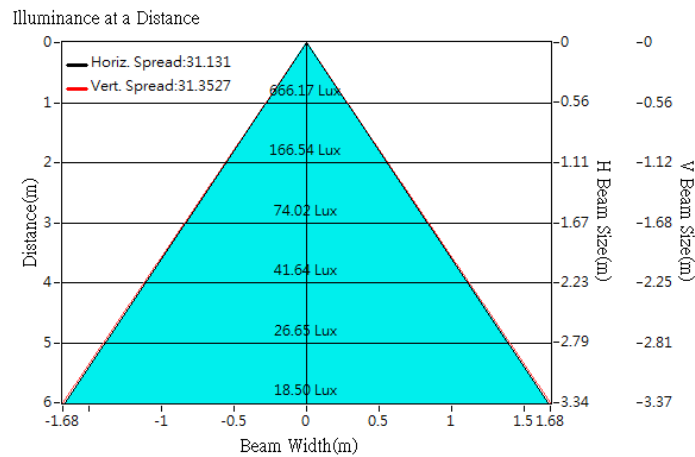



Optical Characteristics

Model Number	CKO-CH19-030015-2505	<p>"H" definition</p> <p>LES CoB "H" mm (distance)</p>
LED	CXM-4-AC40	
LES / LED Size	Φ 4.5 mm	
FWHM (D50)	33°	
Field Angle (D10)	65°	
H (distance)	2.5 mm	
Dimension	Φ =30mm, Thickness=15mm	
Luminous Flux	432 lm Measured @ 4.0 W	
Material	PC / UL94V2	

cd/klm

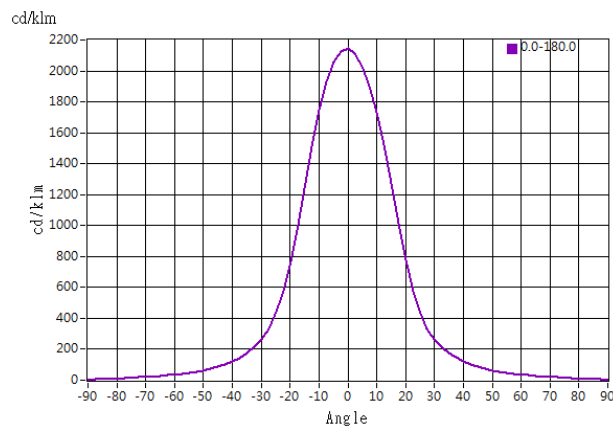

Illuminance At Distances

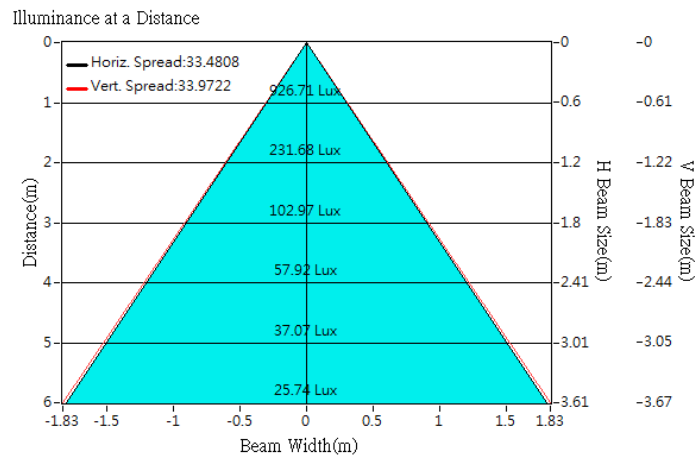



Optical Characteristics

Model Number	CKO-CH19-030015-2505	<p>"H" definition</p>
LED	CXM-6-AC40	
LES / LED Size	Φ 6.3 mm	
FWHM (D50)	40°	
Field Angle (D10)	75°	
H (distance)	2.5 mm	
Dimension	Φ =30mm, Thickness=15mm	
Luminous Flux	683 lm Measured @ 5.0 W	
Material	PC / UL94V2	

cd/klm

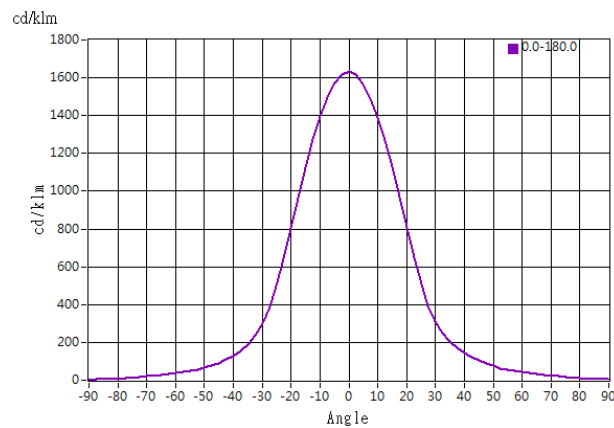

Illuminance At Distances

