



Product Model Number

CKO-CH19-035018-2805

✓ Model Number Definitions

CKO-XXXX-XXXXXX-XXXX



- A. Chun Kuang Optics Corp. Product
- B. Product Type: product abbreviation
Ex:
CH→CoB High Intensity
CC→CoB Compact
CS→Soft Shading for CoB LED
HC→Holder for CoB LED

- C. Identity Code
- D. Lens / Fixture Size
Ex: 075026=Φ75mm / Thickness=26mm (round up)
- E. Serial Numbers

The lens datasheet is applicable for **Luminus LED**, that manufactured by Chun Kuang Optics Corp.

✓ Dimensions (mm) : Φ35 x 17.4

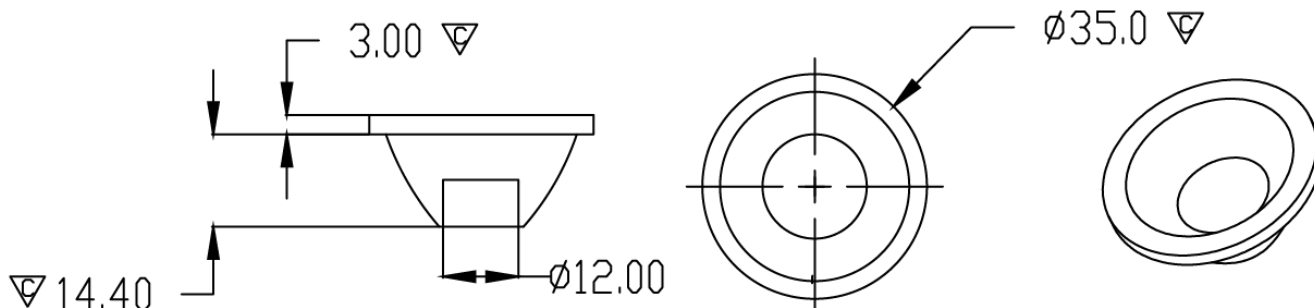

▽:Critical Dimension



Optical Characteristics

| | | | |
|-------------------|---------------------------|------------------|-----------------------|
| Model Number | CKO-CH19-035018-2805 | | <p>"H" definition</p> |
| LED | CXM-3-AC40 | | |
| LES / LED Size | Φ 3.5 mm | | |
| FWHM (D50) | 29° | | |
| Field Angle (D10) | 47° | | |
| H (distance) | 2.5 mm | | |
| Dimension | Φ =35mm, Thickness=17.4mm | | |
| Luminous Flux | 302 lm | Measured @ 2.7 W | |
| Material | PC / UL94V2 | | |

cd/klm

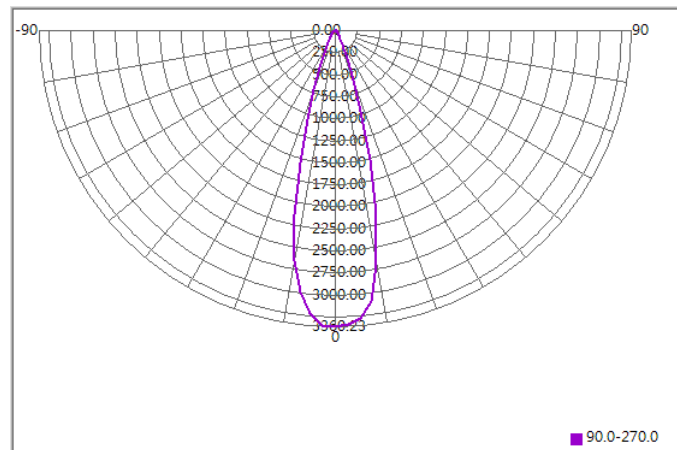

Illuminance At Distances

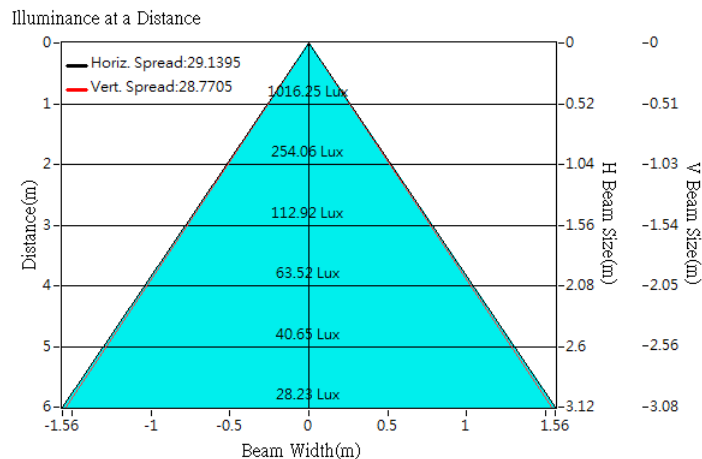



Optical Characteristics

| | | | |
|-------------------|---------------------------|------------------|-----------------------|
| Model Number | CKO-CH19-035018-2805 | | <p>"H" definition</p> |
| LED | CXM-4-AC40 | | |
| LES / LED Size | Φ 4.5 mm | | |
| FWHM (D50) | 29° | | |
| Field Angle (D10) | 49° | | |
| H (distance) | 2.5 mm | | |
| Dimension | Φ =35mm, Thickness=17.4mm | | |
| Luminous Flux | 433 lm | Measured @ 4.1 W | |
| Material | PC / UL94V2 | | |

cd/klm

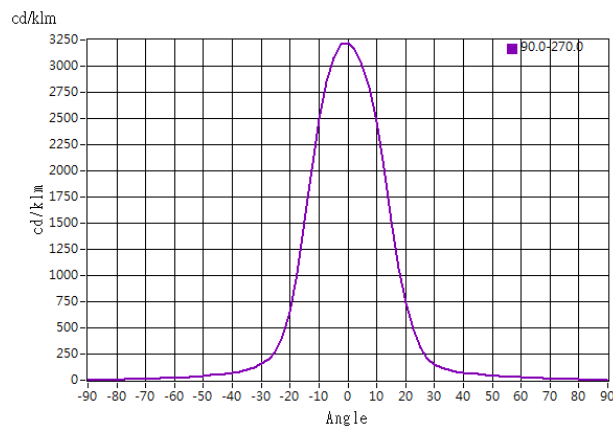

Illuminance At Distances

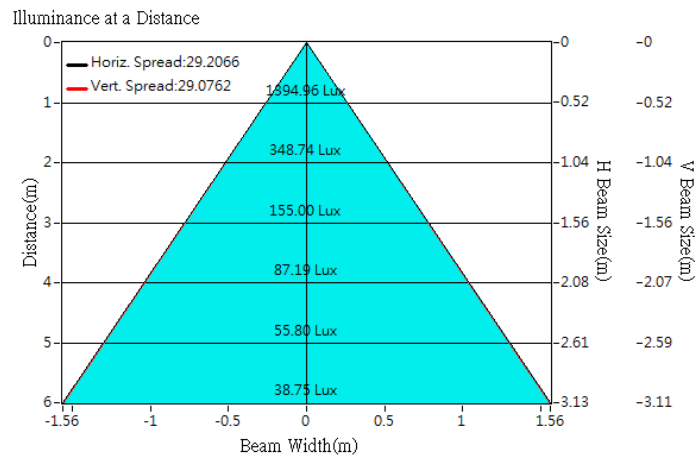



Optical Characteristics

| | | | |
|-------------------|---------------------------|------------------|-----------------------|
| Model Number | CKO-CH19-035018-2805 | | <p>"H" definition</p> |
| LED | CXM-6-AC40 | | |
| LES / LED Size | Φ 6.3 mm | | |
| FWHM (D50) | 35° | | |
| Field Angle (D10) | 55° | | |
| H (distance) | 2.5 mm | | |
| Dimension | Φ =35mm, Thickness=17.4mm | | |
| Luminous Flux | 730 lm | Measured @ 5.0 W | |
| Material | PC / UL94V2 | | |

cd/klm

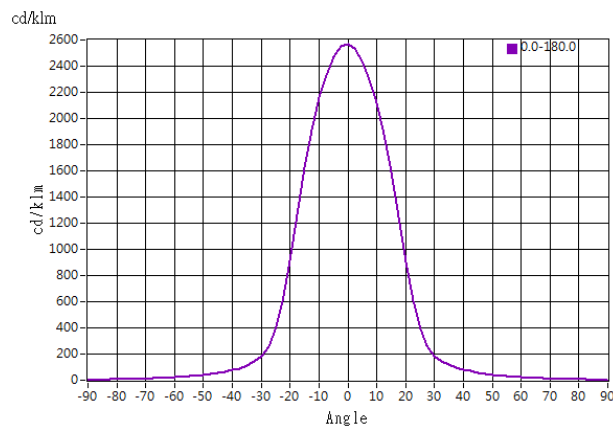

Illuminance At Distances

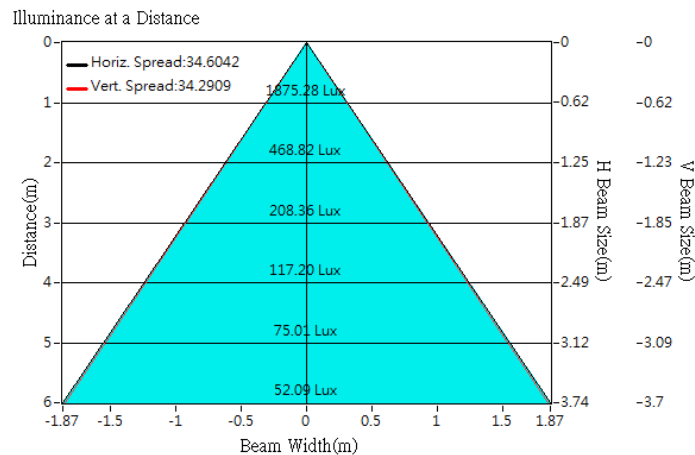



Optical Characteristics

| | | | |
|-------------------|---------------------------|-------------------|--|
| Model Number | CKO-CH19-035018-2805 | | <p>"H" definition</p> <p>LES CoB "H" mm (distance)</p> |
| LED | CXM-9-AC30 | | |
| LES / LED Size | Φ 9.6 mm | | |
| FWHM (D50) | 41° | | |
| Field Angle (D10) | 66° | | |
| H (distance) | 2.5 mm | | |
| Dimension | Φ =35mm, Thickness=17.4mm | | |
| Luminous Flux | 1308 lm | Measured @ 12.1 W | |
| Material | PC / UL94V2 | | |

cd/klm

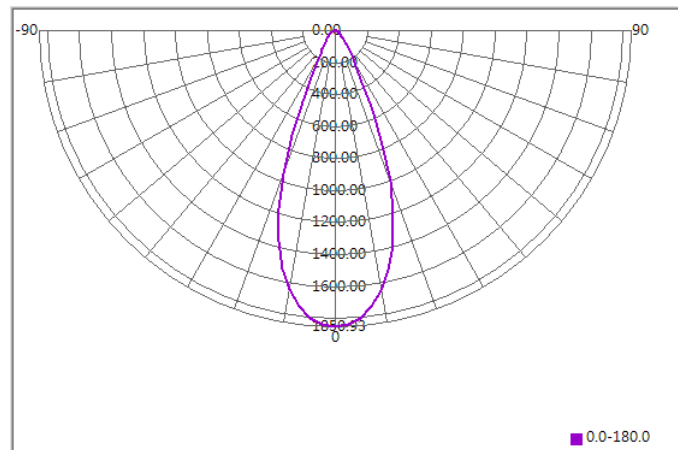

Illuminance At Distances

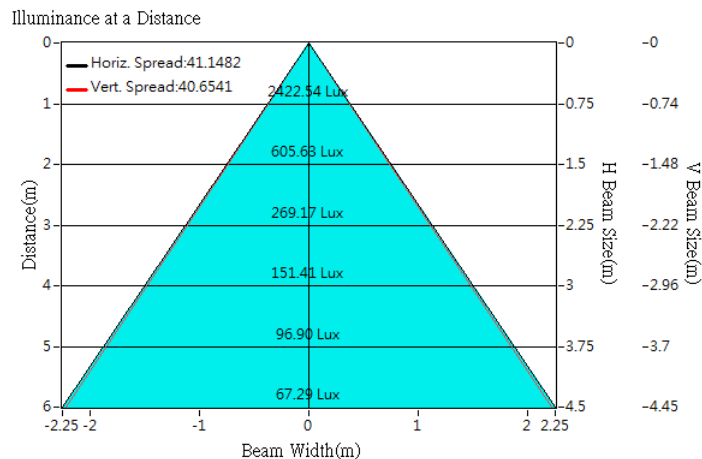



Optical Characteristics

| | | | |
|-------------------|---------------------------|-------------------|--|
| Model Number | CKO-CH19-035018-2805 | | <p>"H" definition</p> <p>LES CoB</p> |
| LED | CXM-9-AC40 | | |
| LES / LED Size | Φ 9.8 mm | | |
| FWHM (D50) | 43° | | |
| Field Angle (D10) | 69° | | |
| H (distance) | 2.5 mm | | |
| Dimension | Φ =35mm, Thickness=17.4mm | | |
| Luminous Flux | 1394 lm | Measured @ 12.1 W | |
| Material | PC / UL94V2 | | |

cd/klm

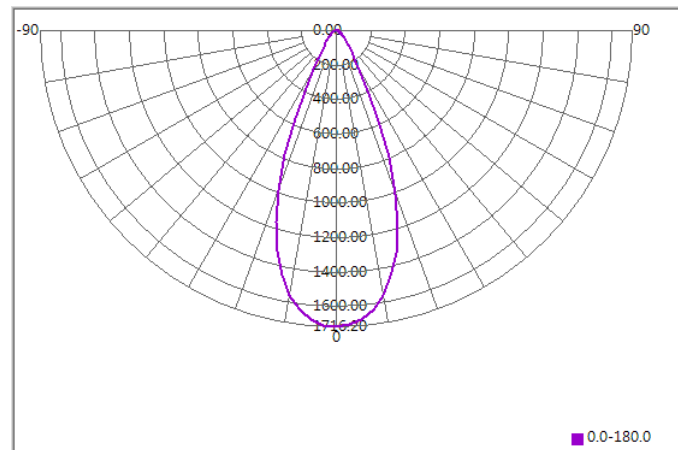

Illuminance At Distances

