



## Product Model Number

CKO-CS18-035018-1301

### ✓ Model Number Definitions

**CKO-XXXX-XXXXXX-XXXX**



- A. Chun Kuang Optics Corp. Product
- B. Product Type: product abbreviation  
Ex:  
CH→CoB High Intensity  
CC→CoB Compact  
CS→Soft Shading for CoB LED  
HC→Holder for CoB LED

- C. Identity Code
- D. Lens / Fixture Size  
Ex: 075026=Φ75mm / Thickness=26mm (round up)
- C. Serial Numbers

The lens datasheet is applicable for **Lumileds LED**, that manufactured by Chun Kuang Optics Corp.

### ✓ Dimensions (mm) : Φ35 x 17.4

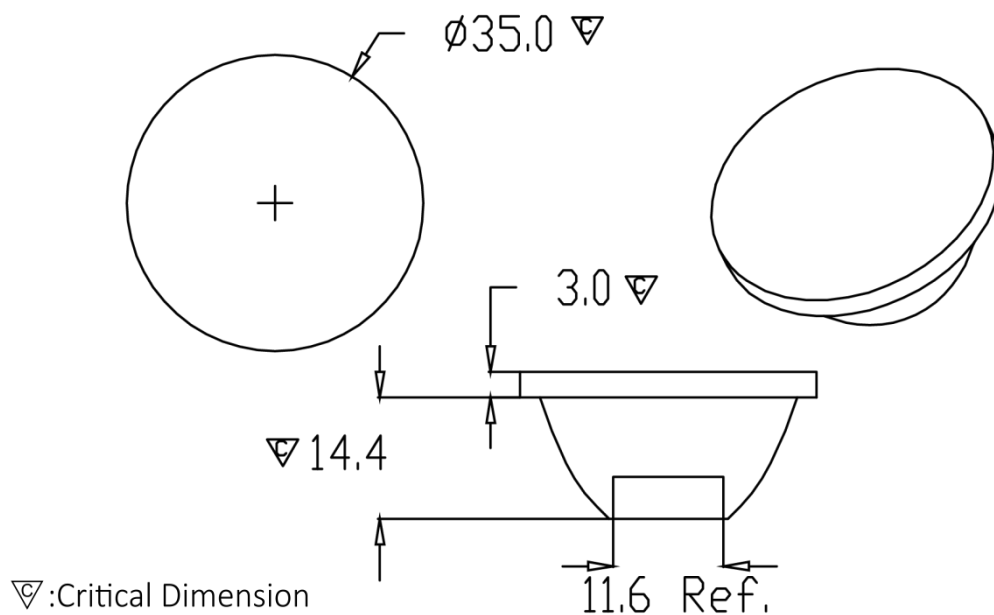





## Optical Characteristics

|                   |                              |                   |                       |
|-------------------|------------------------------|-------------------|-----------------------|
| Model Number      | CKO-CS18-035018-1301         |                   | <p>"H" definition</p> |
| LED               | <b>LUXEON 1202 HD</b>        |                   |                       |
| LES / LED Size    | Φ 6.5 mm                     |                   |                       |
| FWHM (D50)        | 20°                          |                   |                       |
| Field Angle (D10) | 45°                          |                   |                       |
| H (distance)      | 2.5 mm                       |                   |                       |
| Dimension         | Φ =35 mm, Thickness= 17.4 mm |                   |                       |
| Luminous Flux     | 1312 lm                      | Measured @ 10.9 W |                       |
| Material          | PC / UL94V2                  |                   |                       |

## cd/klm

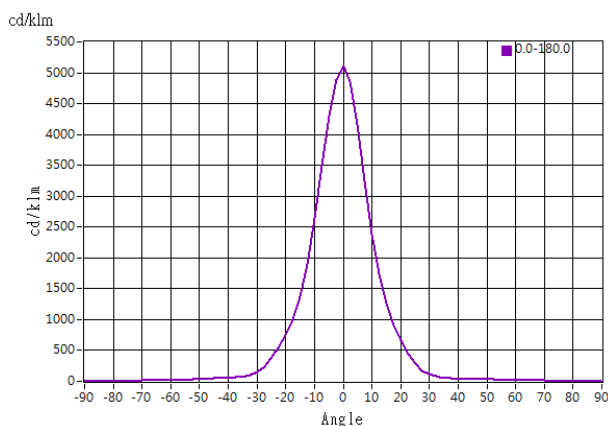

## Illuminance At Distances

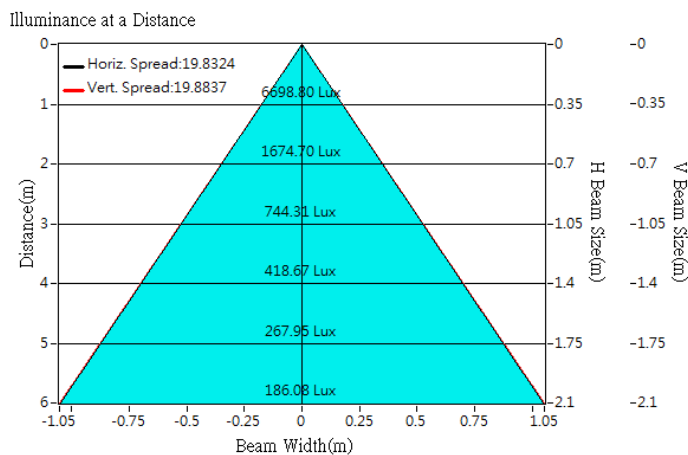



## Optical Characteristics

|                   |                              |                   |                       |
|-------------------|------------------------------|-------------------|-----------------------|
| Model Number      | CKO-CS18-035018-1301         |                   | <p>"H" definition</p> |
| LED               | <b>LUXEON 1203</b>           |                   |                       |
| LES / LED Size    | Φ 9 mm                       |                   |                       |
| FWHM (D50)        | 24°                          |                   |                       |
| Field Angle (D10) | 55°                          |                   |                       |
| H (distance)      | 2.5 mm                       |                   |                       |
| Dimension         | Φ =35 mm, Thickness= 17.4 mm |                   |                       |
| Luminous Flux     | 761 lm                       | Measured @ 11.1 W |                       |
| Material          | PC / UL94V2                  |                   |                       |

## cd/klm

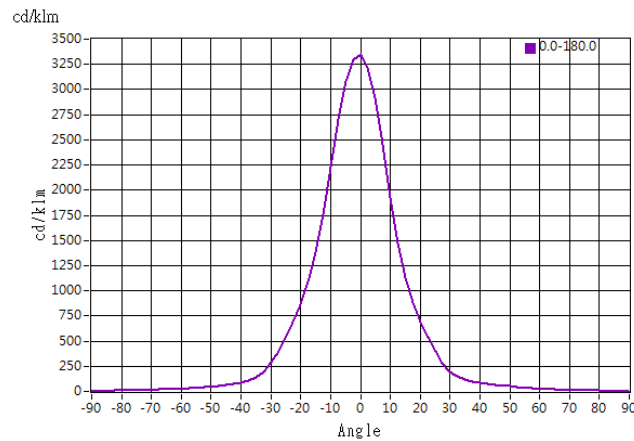

## Illuminance At Distances

