



## Product Model Number

CKO-CU15-034009-9911

### ✓ Model Number Definitions

**CKO-XXXX-XXXXXX-XXXX**



- A. Chun Kuang Optics Corp. Product
- B. Product Type: product abbreviation  
Ex:  
CH→CoB High Intensity  
CC→CoB Compact  
CS→Soft Shading for CoB LED  
HC→Holder for CoB LED

- C. Identity Code
- D. Lens / Fixture Size  
Ex: 075026=Φ75mm / Thickness=26mm (round up)
- C. Serial Numbers

The lens datasheet is applicable for **Cree LED**, that manufactured by Chun Kuang Optics Corp.

### ✓ Dimensions (mm) : Φ33.9 x 8.2

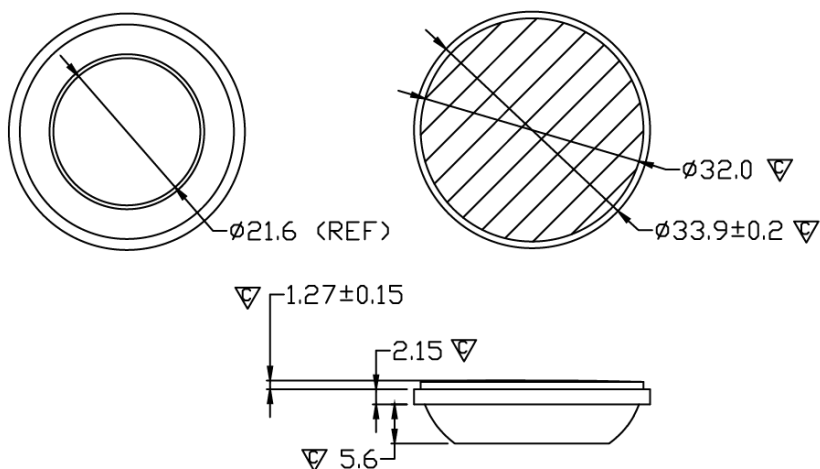

▽:Critical Dimension





## Optical Characteristics

|                   |                               |                  |                       |
|-------------------|-------------------------------|------------------|-----------------------|
| Model Number      | CKO-CU15-034009-9911          |                  | <p>"H" definition</p> |
| LED               | <b>MHD-E</b>                  |                  |                       |
| LES / LED Size    | 7.0 x 7.0 mm                  |                  |                       |
| FWHM (D50)        | 66°                           |                  |                       |
| Field Angle (D10) | 109°                          |                  |                       |
| H (distance)      | 2.4 mm                        |                  |                       |
| Dimension         | Φ =33.9 mm, Thickness= 8.2 mm |                  |                       |
| Luminous Flux     | 874 lm                        | Measured @ 7.5 W |                       |
| Material          | PC / UL94V2                   |                  |                       |

## cd/klm

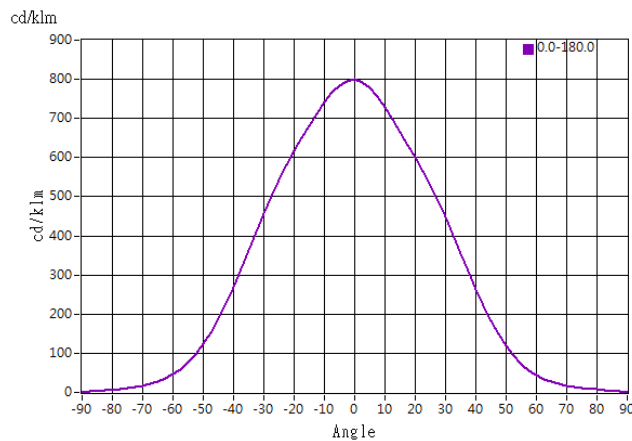

## Illuminance At Distances

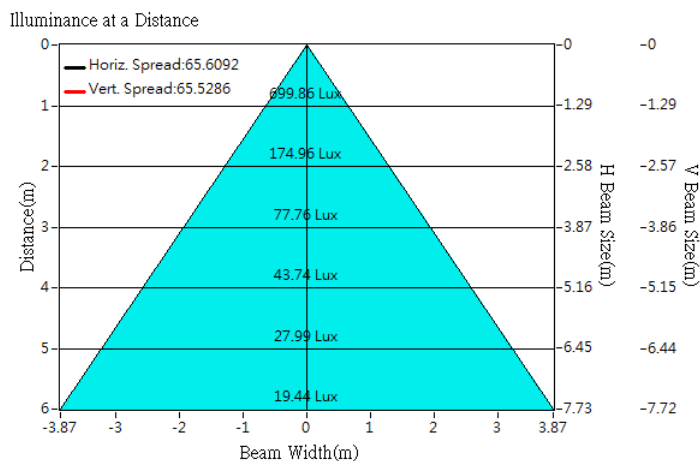



## Optical Characteristics

|                   |                               |                  |                       |
|-------------------|-------------------------------|------------------|-----------------------|
| Model Number      | CKO-CU15-034009-9911          |                  | <p>"H" definition</p> |
| LED               | CXB1304                       |                  |                       |
| LES / LED Size    | Φ 6 mm                        |                  |                       |
| FWHM (D50)        | 68°                           |                  |                       |
| Field Angle (D10) | 111°                          |                  |                       |
| H (distance)      | 2.4 mm                        |                  |                       |
| Dimension         | Φ =33.9 mm, Thickness= 8.2 mm |                  |                       |
| Luminous Flux     | 442 lm                        | Measured @ 3.5 W |                       |
| Material          | PC / UL94V2                   |                  |                       |

## cd/klm

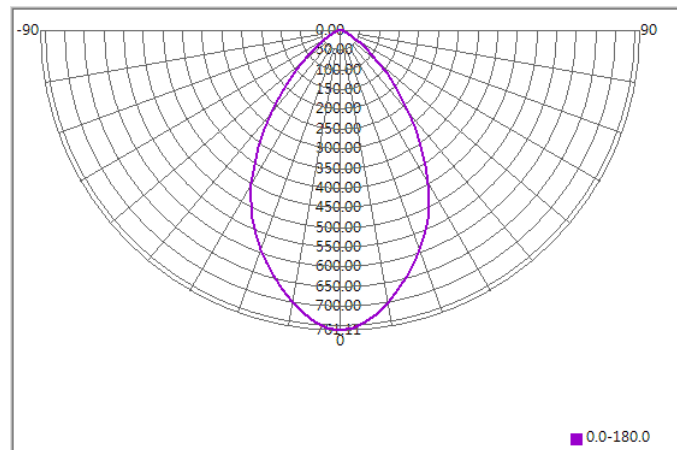

## Illuminance At Distances

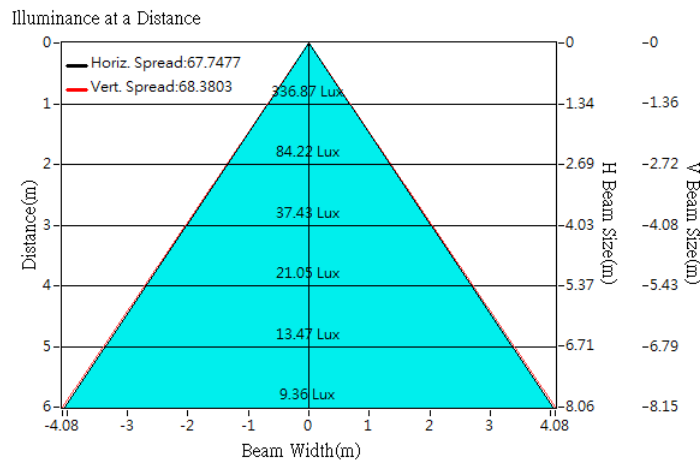



## Optical Characteristics

|                   |                               |                  |                       |
|-------------------|-------------------------------|------------------|-----------------------|
| Model Number      | CKO-CU15-034009-9911          |                  | <p>"H" definition</p> |
| LED               | <b>CMA1306</b>                |                  |                       |
| LES / LED Size    | Φ 6 mm                        |                  |                       |
| FWHM (D50)        | 64°                           |                  |                       |
| Field Angle (D10) | 108°                          |                  |                       |
| H (distance)      | 2.4 mm                        |                  |                       |
| Dimension         | Φ =33.9 mm, Thickness= 8.2 mm |                  |                       |
| Luminous Flux     | 982 lm                        | Measured @ 7.3 W |                       |
| Material          | PC / UL94V2                   |                  |                       |

## cd/klm

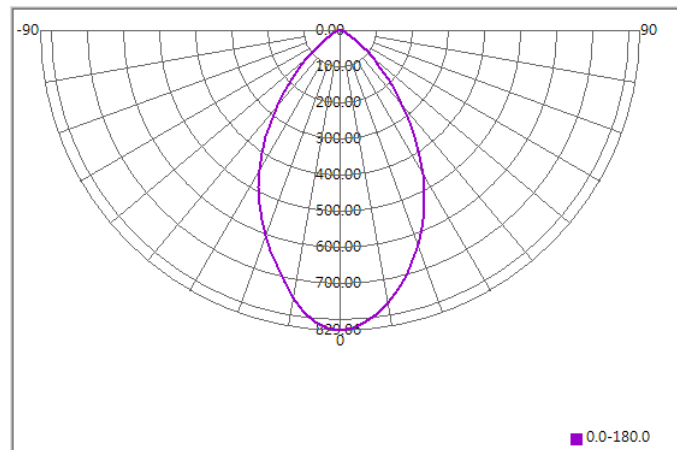

## Illuminance At Distances

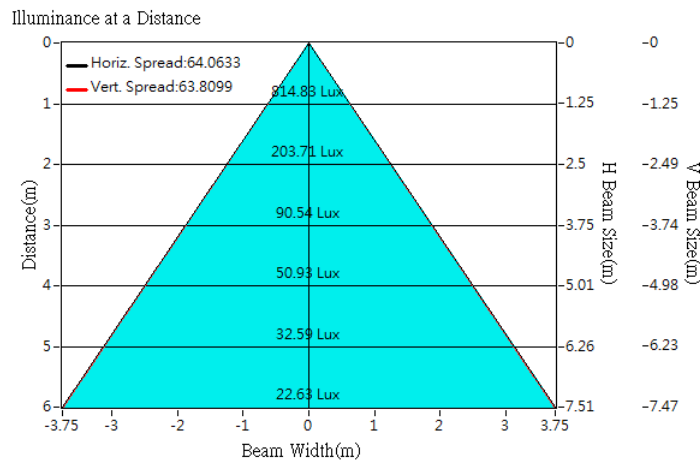



## Optical Characteristics

|                   |                               |                   |                       |
|-------------------|-------------------------------|-------------------|-----------------------|
| Model Number      | CKO-CU15-034009-9911          |                   | <p>"H" definition</p> |
| LED               | <b>CXB1310</b>                |                   |                       |
| LES / LED Size    | Φ 6 mm                        |                   |                       |
| FWHM (D50)        | 64°                           |                   |                       |
| Field Angle (D10) | 109°                          |                   |                       |
| H (distance)      | 2.4 mm                        |                   |                       |
| Dimension         | Φ =33.9 mm, Thickness= 8.2 mm |                   |                       |
| Luminous Flux     | 1503 lm                       | Measured @ 12.1 W |                       |
| Material          | PC / UL94V2                   |                   |                       |

## cd/klm

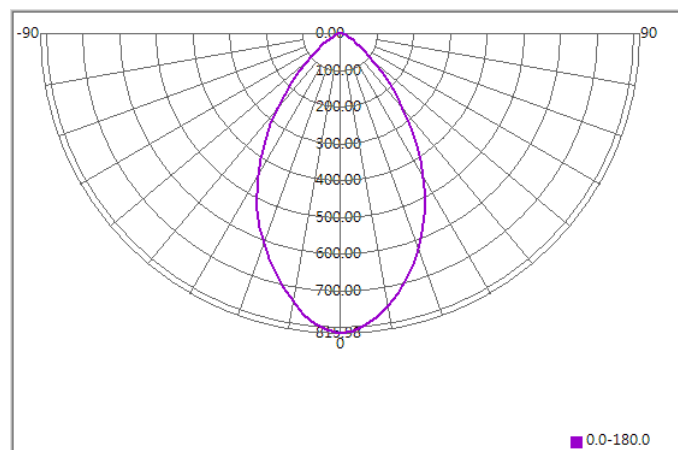

## Illuminance At Distances

