



Product Model Number

CKO-SA16-035016-4805

✓ Model Number Definitions

CKO-XXXX-XXXXXX-XXXX



- A. Chun Kuang Optics Corp. Product
- B. Product Type: product abbreviation
Ex:
CH→CoB High Intensity
CC→CoB Compact
CS→Soft Shading for CoB LED
HC→Holder for CoB LED

- C. Identity Code
- D. Lens / Fixture Size
Ex: 075026=Φ75mm / Thickness=26mm (round up)
- E. Serial Numbers

The lens datasheet is applicable for LED, that manufactured by Chun Kuang Optics Corp.

✓ Dimensions (mm) : Φ34.8 x 15.4

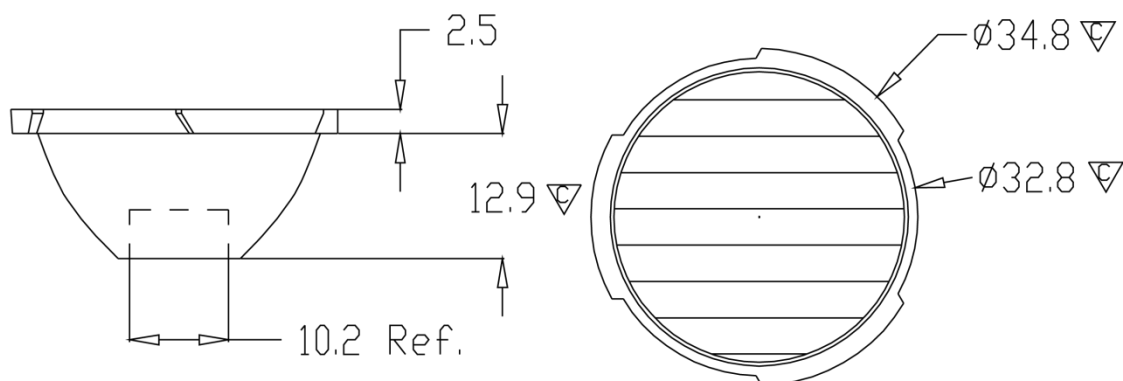

▽:Critical Dimension



Optical Characteristics

Model Number	CKO-SA16-035016-4805		<p>Schematic Diagram</p> 
LED	XD 16		
LES / LED Size	1.6 x 1.6		
FWHM (D50)	6° x 39°		
Field Angle (D10)	17° x 76°		
Dimension with Holder	Φ =34.8 mm, Thickness=15.4 mm		
Luminous Flux	271 lm	Measured @ 1.1 W	
Material	PC / UL94V2		

cd/klm

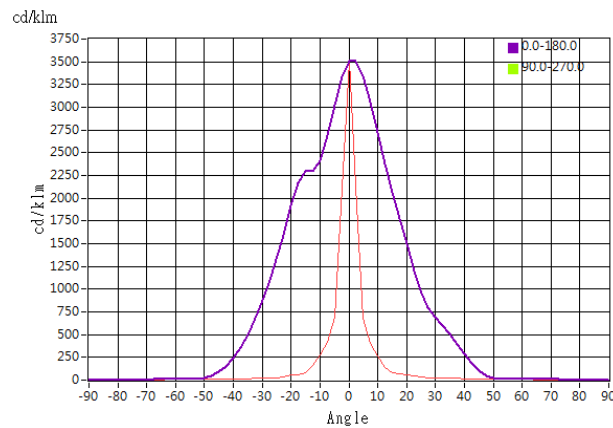

Illuminance At Distances

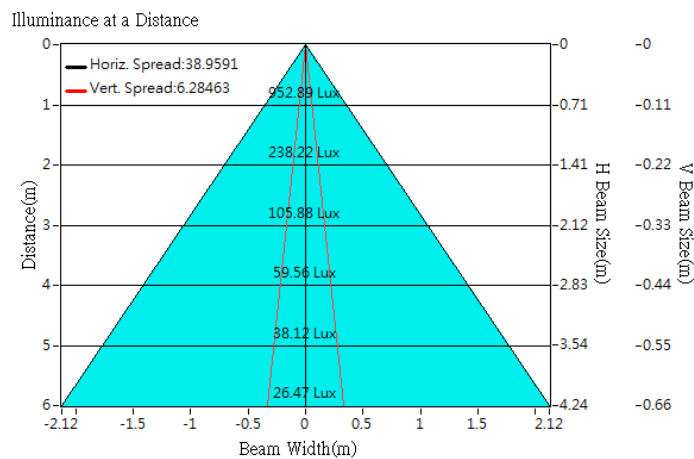



Optical Characteristics

Model Number	CKO-SA16-035016-4805		
LED	XQ-E HI		
LES / LED Size	1.6 x 1.6		
FWHM (D50)	3.6° x 37°		
Field Angle (D10)	9° x 75°		
Dimension with Holder	Φ =34.8 mm, Thickness=15.4 mm		
Luminous Flux	240 lm	Measured @ 1.1 W	
Material	PC / UL94V2		

cd/klm

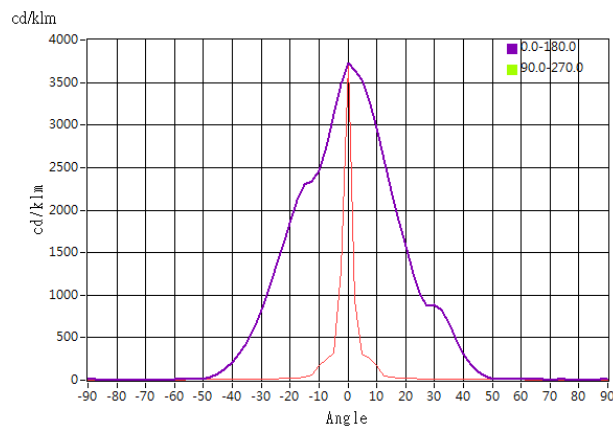

Illuminance At Distances

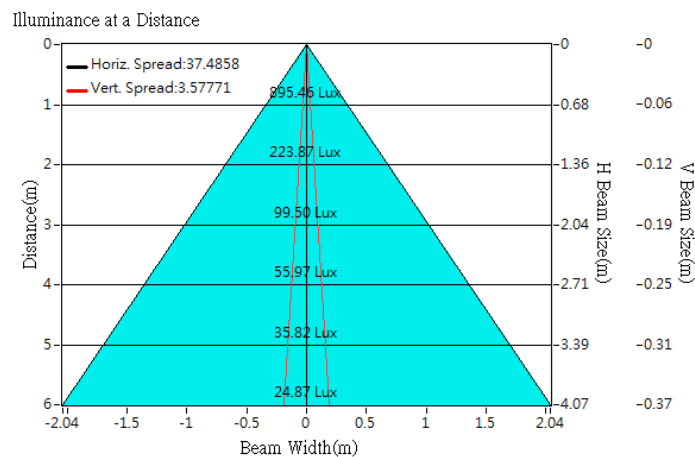



Optical Characteristics

Model Number	CKO-SA16-035016-4805		
LED	XHP35 HI		
LES / LED Size	3.5 x 3.5		
FWHM (D50)	8° x 40°		
Field Angle (D10)	21° x 77°		
Dimension with Holder	Φ =34.8 mm, Thickness=15.4 mm		
Luminous Flux	570 lm	Measured @ 4.0 W	
Material	PC / UL94V2		

cd/klm

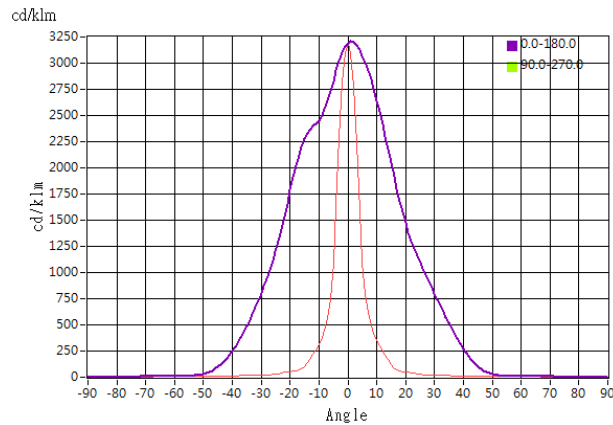

Illuminance At Distances

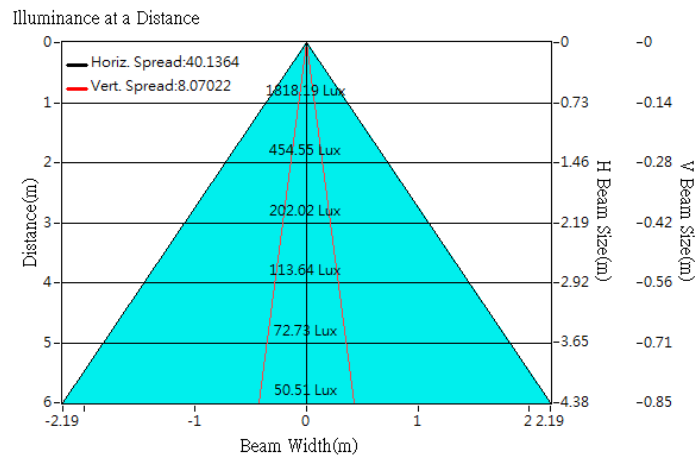



Optical Characteristics

Model Number	CKO-SA16-035016-4805		
LED	XP-E2		
LES / LED Size	3.5 x 3.5		
FWHM (D50)	5° x 37°		
Field Angle (D10)	14° x 71°		
Dimension with Holder	Φ =34.8 mm, Thickness=15.4 mm		
Luminous Flux	270 lm	Measured @ 1.2 W	
Material	PC / UL94V2		

cd/klm

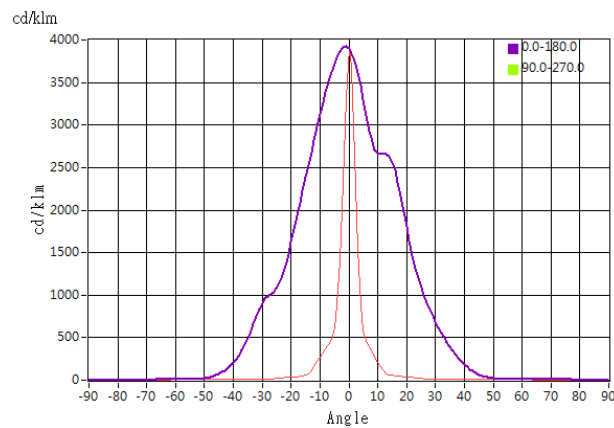

Illuminance At Distances

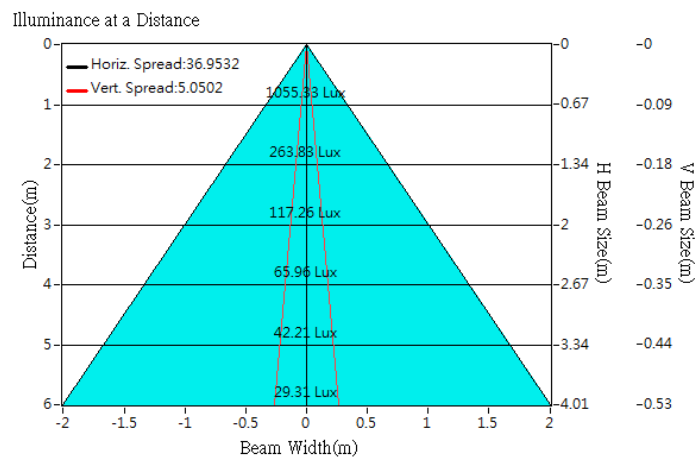



Optical Characteristics

Model Number	CKO-SA16-035016-4805		
LED	XP-G3		
LES / LED Size	3.5 x 3.5		
FWHM (D50)	8° x 40°		
Field Angle (D10)	22° x 77°		
Dimension with Holder	Φ =34.8 mm, Thickness=15.4 mm		
Luminous Flux	255 lm	Measured @ 1.1 W	
Material	PC / UL94V2		

cd/klm

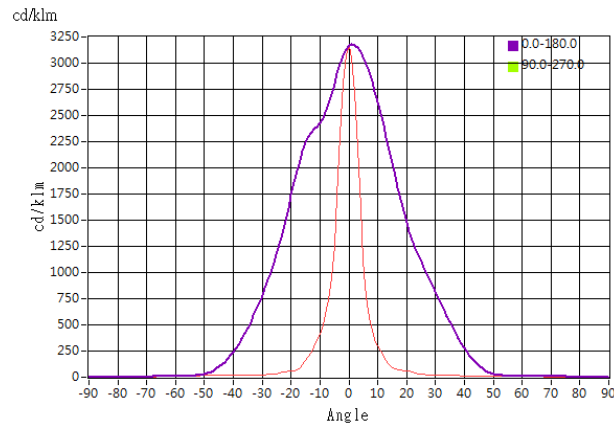

Illuminance At Distances

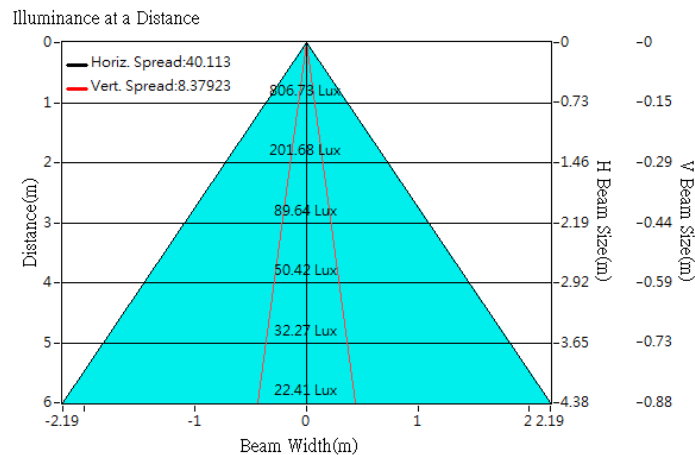



Optical Characteristics

Model Number	CKO-SA16-035016-4805		
LED	XP-L HD		
LES / LED Size	3.5 x 3.5		
FWHM (D50)	9° x 40°		
Field Angle (D10)	24° x 77°		
Dimension with Holder	Φ =34.8 mm, Thickness=15.4 mm		
Luminous Flux	578 lm	Measured @ 4.0 W	
Material	PC / UL94V2		

cd/klm

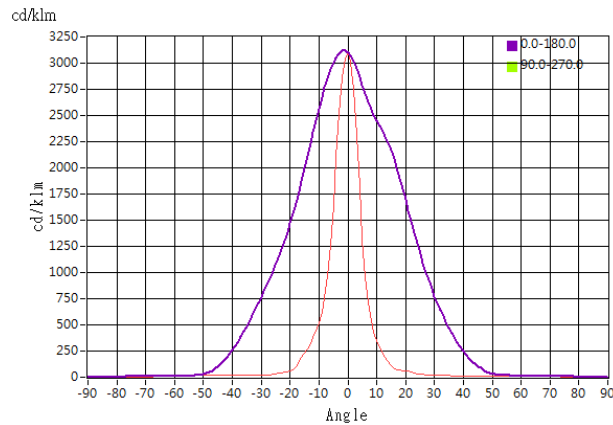

Illuminance At Distances

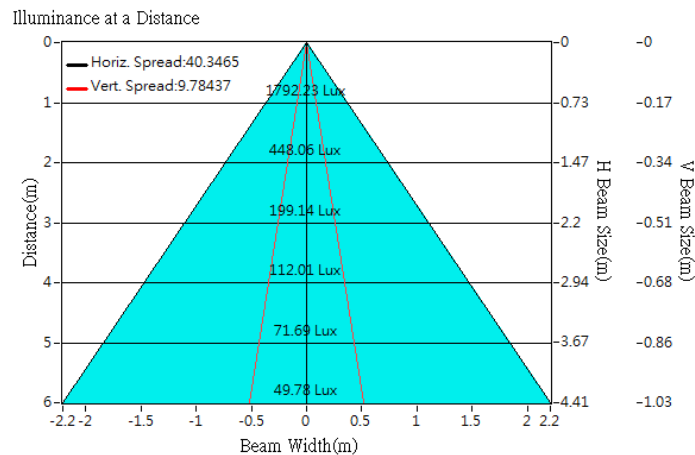



Optical Characteristics

Model Number	CKO-SA16-035016-4805		
LED	XP-L HI		
LES / LED Size	3.5 x 3.5		
FWHM (D50)	6° x 40°		
Field Angle (D10)	18° x 77°		
Dimension with Holder	Φ =34.8 mm, Thickness=15.4 mm		
Luminous Flux	733 lm	Measured @ 3.7 W	
Material	PC / UL94V2		

cd/klm

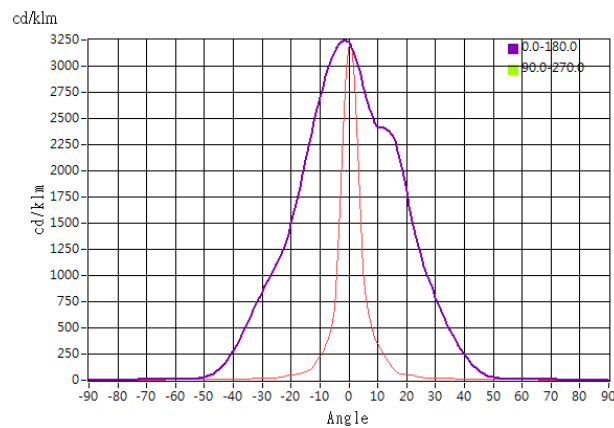

Illuminance At Distances

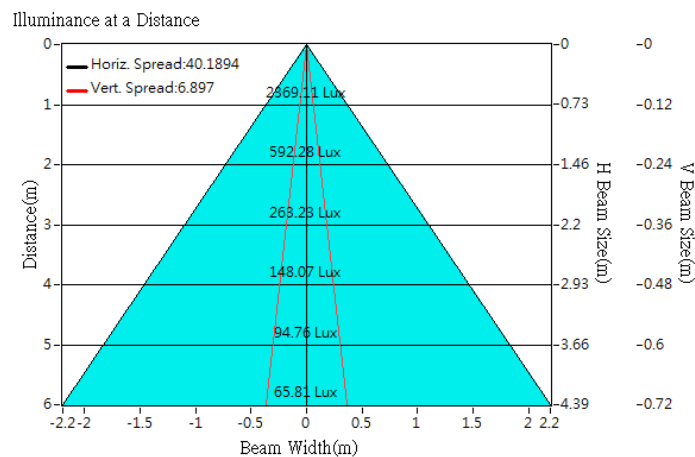



Lens Accessories - Lens Holder

Product Model	Size (mm)	Material
CKO-HL16-035020-3801	34.8 x 19.1	PC-V0

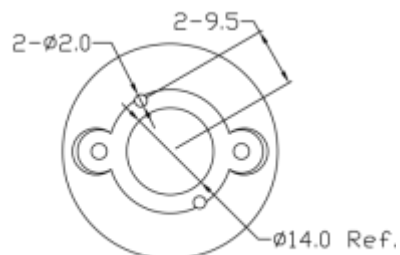
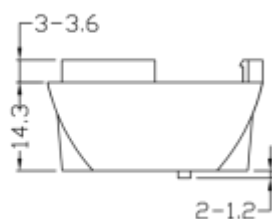
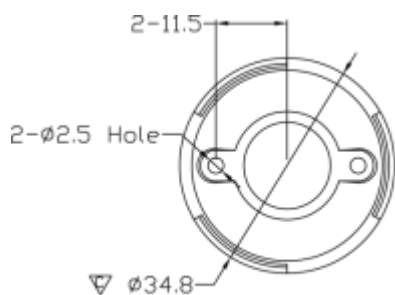

Bottom view

▽:Critical Dimension